

MODEL NO.: 342 CATALOG: PC-12-MOM-(1)
DESCRIPTION: RECIRCULATING, FLUSHING TOILET
VOLTAGE: 12 VOLT D.C. OR 32 VOLT D.C. _____
MATERIAL: BRONZE, PLASTIC, ETC. _____
COLOR: _____

↓
800 W. Artesia
Compton, CA
(310) 638-8445

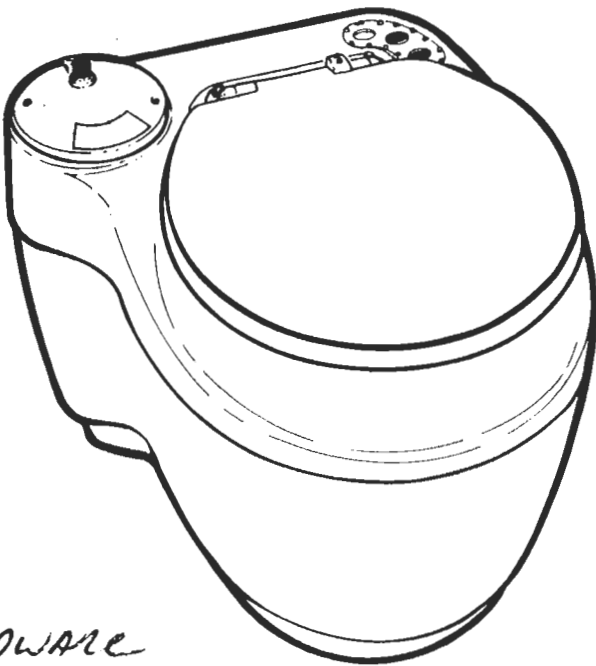

↓
Associated
Supplier
MARINE HARDWARE
Tony (310) 831-9261

OWNER'S MANUAL
GENERAL INFORMATION
OPERATING PROCEDURE
INSTALLATION INSTRUCTIONS
SERVICE/PARTS

**MARINE
MONOMATIC®
SANITATION SYSTEM**
MODEL NO. 342
(FORMERLY 1-SE)

GENERAL INFORMATION

PRISMATIC MONOMATIC® SANITATION SYSTEM

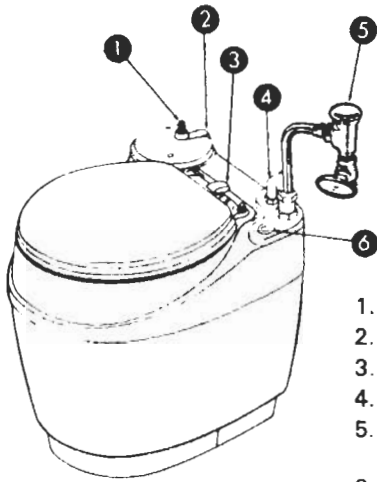

1. Flush Button
2. Electrical Connection
3. Sealed Bowl Actuator
4. Vent Connection
5. Water Inlet Apparatus (Optional)
6. Prismatic Level Indicator

This is the original self-contained toilet designed by Monogram Industries, Inc., the world's leading recirculating flush toilet manufacturer—supplier for aircraft, trains, buses, boats, public use, vacation homes, as well as recreational vehicles. The standard Monomatic® operates on the same principles as the Monogram equipment used exclusively in Boeing 747, 707, 737 and Lockheed L-1011 jumbo jets.

SPECIAL FEATURES

Sealed Bowl Mechanism

SEALED BOWL MECHANISM is operated by raising seat lid. When the lid is in the open position, the bowl flap is in the open position.

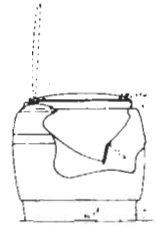

Level Indicator

At all times prior to the unit being $\frac{3}{4}$ full the level indicator will appear LIGHT. When the unit is $\frac{3}{4}$ full the PRISMATIC indicator will appear DARK until unit is discharged.

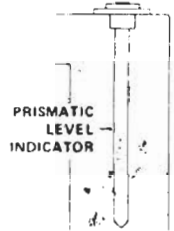

The Monomatic® requires only 4 gallons of fresh water. Push button actuates eight-second flushing cycle, recirculating fluid through filter, but retaining waste material in holding tank. Positive bowl seal prevents odor-leak. Self-cleaning filter eliminates messy maintenance. Tank holds 4 gallons of waste material. If desired, toilet may be connected to auxiliary waste holding tank for extended capacity.

MODEL NUMBERS

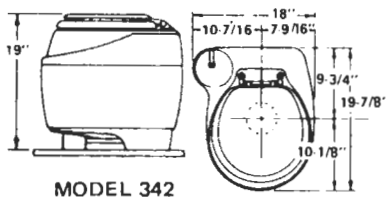

MODEL 342

The Monomatic® Model 342 has a capacity of eight gallons and requires an initial charge of four gallons of water mixed with one package of Monochem chemical or specified quantity of Monochem® L10™ liquid. (Available in White and Harvest Gold.)

OPERATING PROCEDURES

CHARGING

CHARGING WITH WATER—The initial charge of water for starting the recirculating process is 4 gallons and the total capacity (including the charge) is 8 gallons.

Pour 4 gallons of water into toilet through bowl. If optional Water Inlet Assembly is attached (Optional), turn on water pressure so water can pass through rinse and fill tube into tank. The end of the tube is positioned within the tank at the four-gallon level. A readily apparent change in the sound indicates the charge level has been reached and water should be shut off.

(Note: A partial flush would indicate more water is required. Occasional dry flushing will not harm the mechanism. The pump portion of the flushing mechanism is located at the appropriate charge level; therefore, the pump will not be submerged until the appropriate charge level has been reached.)

Fresh water is recommended for charging; however, use of salt water is permitted. If salt water is used, the unit should be thoroughly rinsed, when convenient, with fresh water.

CHARGING WITH CHEMICAL—When the unit is properly charged with water, press the flush button and pour contents of one package of Monochem T5™ powder or specified quantity of Monochem L-10™ liquid into the bowl **while the Monomatic® is flushing**. Flush several times in order to dissolve the chemical. Add chemical every 10 flushes.

Marine Monomatic® sanitation system Warranty does not cover use of any chemical other than Monochem™ or an equivalent which is not harmful or injurious to the tank, bowl, housing, motor, drive, gears and all other moving parts.

TOILET TISSUE

RECOMMENDED TYPE—We recommend our own Monex Toilet Tissue. Specifically formulated for recirculating toilets, Monex is clog-free and biodegradable. If Monex is not available, standard brands of single-ply non-facial toilet tissue, such as Zee or M.D., may be used. We do not advise using Aqua Soft, Dissolve Away or Pom—tissue developed for non-recirculating toilets with holding tanks and which dissolve into extremely fine particles.

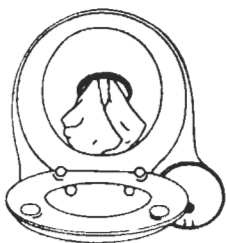

RECOMMENDED USE—Long ago, hospitals discovered how to employ toilet tissue in a static sanitation device. Hospital management journals recommend, as standard operating procedure, that nurses place a few pieces of toilet tissue in the bowl, prior to use. Tissue should be folded in "V" form, as shown. This facilitates removal of solid wastes from the bowl.

DANGER — POISON

Contains formaldehyde and methanol. Cannot be made non poisonous. Avoid contact with skin, eyes, and mucous membranes. Prolonged or repeated contact may cause allergic reaction.

In case of contact, flush with water for 15 minutes. For eyes, get prompt medical attention.

If swallowed, give 1 or 2 glasses of water or milk. Induce vomiting and call physician immediately.

KEEP OUT OF REACH OF CHILDREN

DISCHARGING

If allowed to operate to maximum capacity, the fluid level in the tank will rise to the point where it becomes visible at the bottom of the bowl. **Do not let fluid rise above bowl outlet.**

There are two basic methods of discharge for the Marine Monomatic® sanitation system. These methods are:

1. **DOCKSIDE DISCHARGE METHOD.**
 - a. Start dockside pump.
 - b. When empty (approximately 30 seconds or a noted sound change), stop dockside pump.
 - c. Recharge with fresh water.
2. **OVERBOARD DISCHARGE METHOD (UTILIZING HAND-O-PUMP®).**
 - a. Open seacock.
 - b. Operate hand pump.
 - c. When empty (approximately 30 seconds or noted sound change).
 - d. Close thru-hull seacock.
 - e. Recharge with fresh water.

CAUTION: KEEP SEACOCK CLOSED EXCEPT WHEN DISCHARGING.

CLEANING

1. Empty toilet.
2. Lift cartridge as shown in Fig. 5, making sure motor is above toilet.
3. Pour one cup of Vanish or equivalent cleaner into bowl.
4. Fill Monomatic® to within 1" of brim with water. Flush 3 times. Let solution remain for at least 5 minutes, **but no longer than one hour.**
5. Rinse thoroughly.

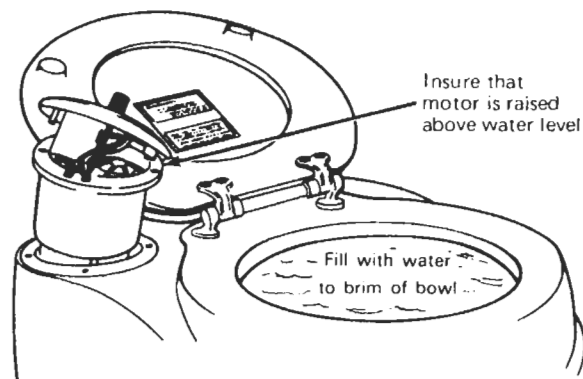

Thorough cleaning of bowl and flush ring without disconnecting filter.

INSTALLATION INSTRUCTIONS (MOUNTING)

PRELIMINARY PROCEDURE

1. Determine Monomatic® location and space requirement by use of template provided. Be sure to allow for tubing connections. For most efficient operation, sewage tubing runs should be as short as possible.
2. Approximate the length(s) of Monoflex tubing* required. See tubing instructions.
3. Make certain that electrical hook-up wire is available.
4. Begin installation by following the instructions called out in the following sections:

Mounting instructions

Tubing installation

Discharge Methods

Water and vent connection

Electrical instructions

*Monoflex tubing has been especially formulated for use with the Marine Monomatic sanitation system. It is designed to withstand long exposure to waste; no substitution should be made.

MOUNTING INSTRUCTIONS

MODEL 342 MOUNTING

There are two methods of installation; side discharge and rear discharge. Determine which method is most applicable to your installation and follow the appropriate instructions below.

1. SIDE DISCHARGE (LEFT OR RIGHT)

For side outlet mounting installation, use template and drill hole pattern "A" using a 5/16" drill for the 1/4" x 20 insert and a 5/32" drill for the 3 No. 12 wood screws.

Screw bracket "A" to the floor. Install 1/4" x 20 insert as per Fig. 2. Attach space saver fitting and mounting brackets to underside of Monomatic® using 1/4" x 20 bolts.

Place Monomatic® in position and wedge rear mounting bracket under bracket "A". Push toilet back until it is firmly wedged. Insert 1/4" x 20 bolt thru the front mounting bracket and tighten securely, as shown in Fig. 1.

2. REAR DISCHARGE

For rear mounting installation, use template and drill hole pattern "B" using a 5/16" drill. Install 1/4" x 20 inserts as per Fig. 3. Attach discharge chute and mounting brackets to underside of Monomatic® using 1/4" x 20 bolts and washers. Discard bracket "A" and bolt toilet down using two 1/4" x 20 bolts as shown in Fig. 3.

ACCESSORY PRODUCTS AVAILABLE FOR INSTALLATION

DOCKSIDE SERVICE FITTING #119170

1 1/2" gunwale fitting connecting to dockside pump for discharge of Monogram systems. Marked "Waste." Finish is high-lustre chrome over pressure-cast bronze.



WATER INLET ASSEMBLY #119747

Water inlet assembly is available as an option. Assembly includes chrome-plated anti-siphon vacuum breaker, custom water inlet fitting, and water shut-off valve. Water shut-off valve is 3/8" FPT.



VENT FITTING #119171

Thru-hull fitting provides positive ventilation system. Vent fitting furnished with 90° 3/8" I.D. hose adapter.

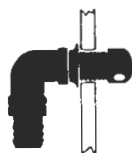

DUAL DISCHARGE TEE FITTING #119172

This fitting provides both dockside, as well as overboard, discharge capability to Monogram systems with HAND-O-PUMP®II and DOCKSIDE SERVICE FITTING.



DELUXE MONOFLEX HOSE

1 1/2" I.D. DISCHARGE HOSE, highly flexible, smooth bore, constructed of highly durable PVC compounds. Available with bondable PVC end cuffs (easily adapt to all standard 1 1/2" as well as oversized hose fittings) and Monoflex #KMA adhesive (specially formulated cement for use with all flexible PVC plastics).



HAND-O-PUMP®II MODEL #751

Monogram's new compact plastic HAND-O-PUMP®II may be used to transfer waste to an on board holding tank, as a manual bilge pump, or to pump waste overboard in unrestricted areas. The lightweight pump is capable of transferring 15 gallons a minute.



SPACE-SAVER MOUNTING ASSEMBLY

ITEM	DESCRIPTION	QUANTITY
1	Monomatic®	1
2	1/4" x 20 Hex Head Bolts	2
	1/4" x 20 Hex Head Nut	1
3	Mounting Brackets #M11000	2
4	Discharge Chute	1
5	1/4" x 20 x 3/4" Round Head Bolt	4
6	#12 x 3/4" Wood Screws, Side Mounting Only . . . 3	
7	Bracket "A" #M11001, Side Mounting Only . . . 1	
8	Insert, Side Mounting	1
	Insert, Rear Mounting	2

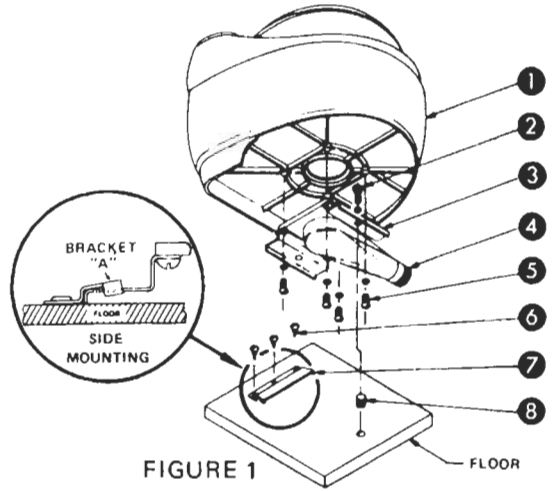

FIGURE 1

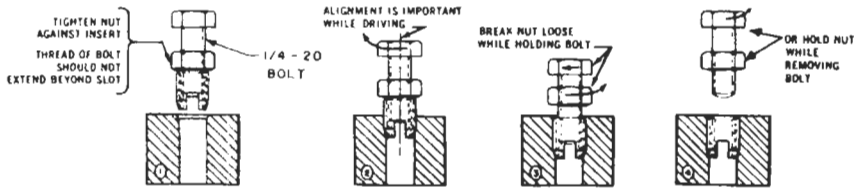

FIGURE 2

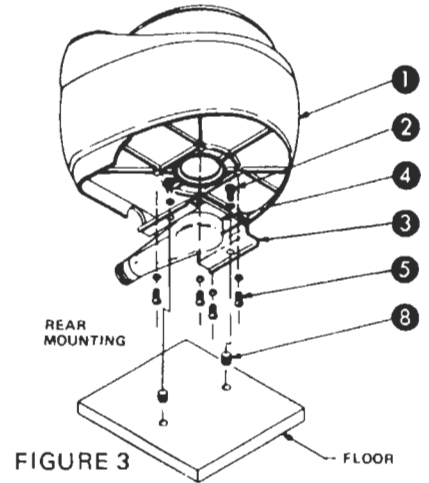
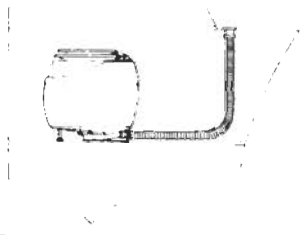

FIGURE 3

INSTALLATION INSTRUCTIONS (DISCHARGE)

DISCHARGE METHODS



Dockside Discharge Only—Wastes are removed via 1½" MONOFLEX TUBING from SPACE-SAVER DISCHARGE ADAPTER, located at the base of the MONOMATIC, to a DOCKSIDE SERVICE FITTING.

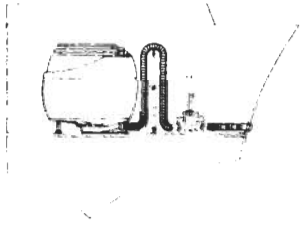

Overboard Discharge Only—For use in unrestricted areas where dockside pump stations are not yet installed. Wastes are removed by means of the HAND-O-PUMP® II and are discharged directly overboard. Note: Thru-hull fitting may be located above or below water line.

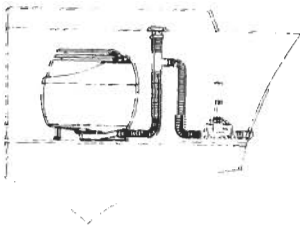

Dual Discharge Method—For overboard, as well as dockside discharge, the MONOMATIC® is installed with a DUAL DISCHARGE TEE FITTING, DOCKSIDE SERVICE FITTING, and HAND-O-PUMP® II.

PRECAUTIONARY NOTE

IF ANY PORTION OF THE MONOMATIC® IS MOUNTED BELOW THE WATERLINE AND IS CONNECTED TO A THRU-HULL FITTING WHICH IS ALSO BELOW THE WATERLINE WHEN BOAT IS UNDERWAY, AT REST, OR UNDER MAXIMUM LOADING, THE FOLLOWING PROCEDURE MUST BE OBSERVED:

Obtain marine-type 1½" vented loop (Wilcox-Crittenden or equivalent). Mount vented loop to boat at any convenient location between Monomatic® and seacock at an elevation which is at least four inches above water line when boat is at greatest angle of heel. Route tubing from pump to vented loop and from vented loop to seacock.

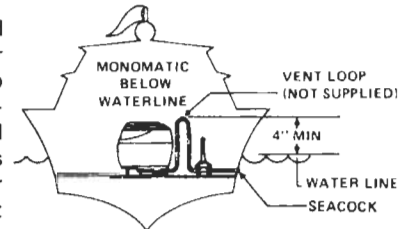

IMPORTANT SAFETY NOTICE

This procedure IS NOT a substitute for the seacock. The above precautionary measure is intended to prevent back filling or siphoning of water into the Monomatic® during the brief period of time the seacock is open before and after discharge pump is used.

KEEP SEACOCK CLOSED WHEN NOT IN USE.

TUBING INSTALLATION

Plan Monoflex tubing length and routing. Note: End-cuffs should be assembled prior to routing tubing. Cut round clearance holes (two inches in diameter), through non-structural bulkheads, where necessary. Care should be taken that penetrations through bulkheads are free of burrs which could damage tubing when subject to normal marine vibration. Cut appropriate length of Monoflex tubing and trim ends squarely. Area to be cemented must be free of dirt, grease or oil film. If necessary, clean area to be bonded with solvent such as acetone or MEK. Do not use kerosene, gasoline, or any solvent which leaves oil film.

Apply #KMA adhesive to four or five threads of hose. Do same for end-cuff. Immediately thread end-cuff on hose. Insure that end-cuff is screwed on until tubing thread bottoms (approximately 1¾ inches).

CAUTION: ALLOW ABOUT 15 MINUTES BEFORE HANDLING AND 24 HOURS BEFORE USING JOINT.

Route Monoflex tubing assembled with end-cuffs through clearance holes. Slip end-cuffs over appropriately sized fittings and secure with band clamp. Be sure entire tubing length is free of twists or kinks.

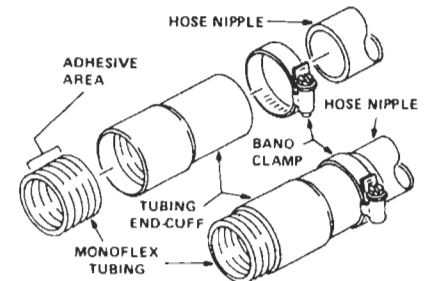

DOCKSIDE DISCHARGE



1. Route 1 1/2" tubing from discharge chute located at base of Monomatic® directly to Dockside Service Fitting.
2. Apply sealant to underside of flange on the Dockside Service Fitting, Item #1. Place Dockside Fitting into hole and secure with No. 8" x 3/4" Oval Head Screws, Item #2.

NOTE: Dockside Service Fitting must be mounted above top of Marine Monomatic®.

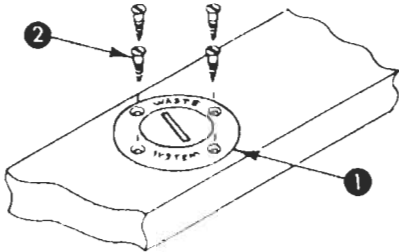

2. Mount HAND-O-PUMP® at some convenient place near the Monomatic® at a level high enough to allow a minimum of 12" between the bottom of the Monomatic® and the suction inlet of the pump. This is to keep the pump dry between discharges. Continue tubing so as to form loop 18" from floor as shown.

SEE PRECAUTIONARY NOTE ON OPPOSITE PAGE.

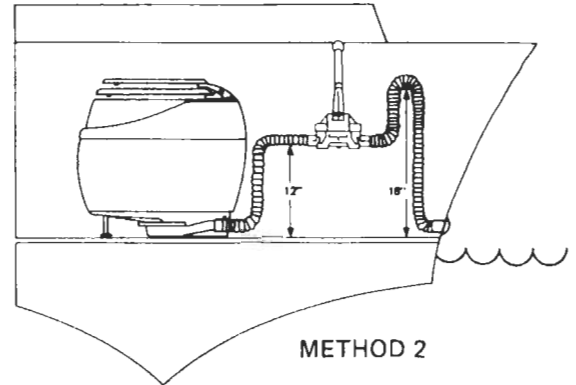

OVERBOARD DISCHARGE

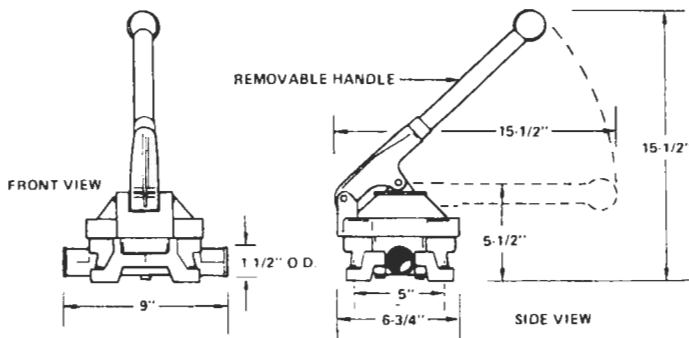
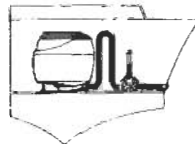

There are two mounting methods for the HAND-O-PUMP® II overboard discharge pump.

1. Route tubing from Monomatic® to pump so as to form an 18" loop from the floor. Continue tubing from pump to discharge outlet.

SEE PRECAUTIONARY NOTE ON OPPOSITE PAGE.

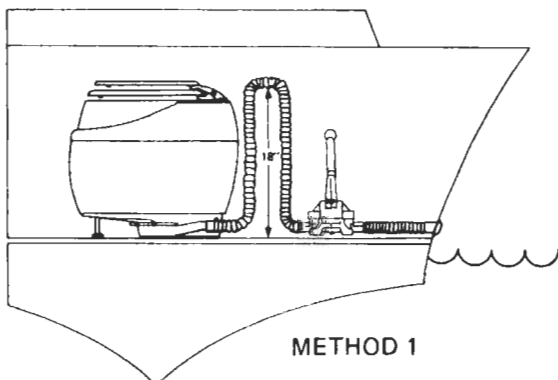

DUAL DISCHARGE



Install as shown, utilizing a DUAL DISCHARGE TEE FITTING to connect Dockside Discharge Hose to Overboard Discharge Pump.

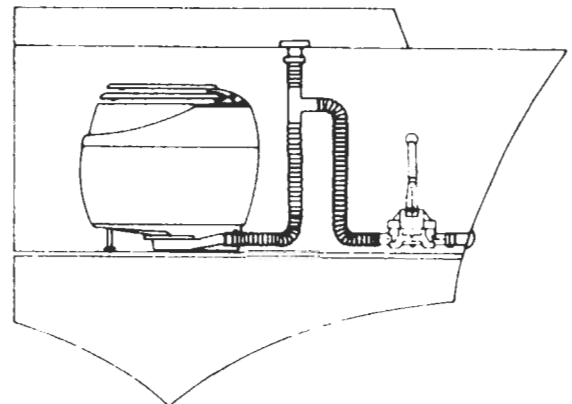

EXTENDED CAPACITY

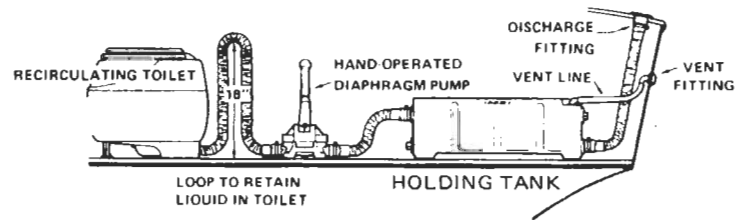

INSTALLATION INSTRUCTIONS (WATER, VENT, ELECTRICAL)

WATER CONNECTION

WATER INLET ASSEMBLY is available as an option. Assembly includes chrome-plated anti-siphon vacuum breaker, custom water inlet fitting, and water shut-off valve. Can be adapted to "E" models with male adapter GHT x 1/2" MPT. Water shut-off valve is 3/8" FPT.

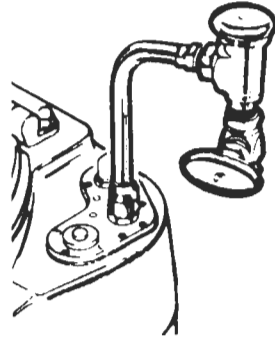

VENT CONNECTION

All fittings shown are included in VENT KIT (optional).

NOTE: VENTING LINE MUST BE COMPLETELY ABOVE TOILET

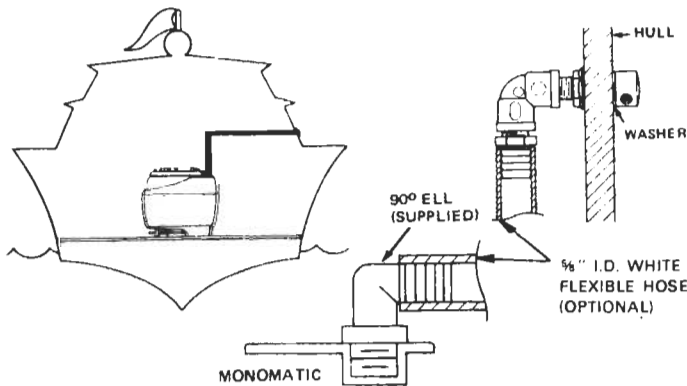

ELECTRICAL LAYOUT

Connect the power leads that emerge from the cartridge cover directly to a 12 Volt D.C. or 32 Volt D.C. power source. If an additional power lead length is necessary, use #14 gauge wire. NOTE: It is not necessary to install a fuse in the power supply lead. For protection of the Monomatic, a 10-amp fuse*, located within the motor chamber is factory-installed.

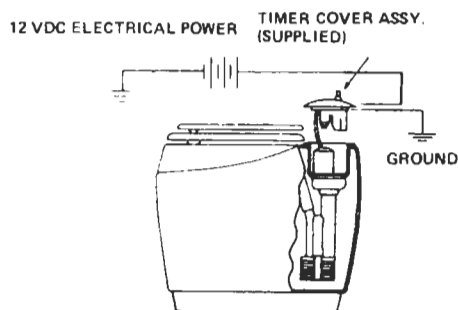

*A five-amp fuse is used in 32 volt systems

SERVICE/PARTS INFORMATION

SYMPTOMS	CORRECTIVE PROCEDURE
ROUTINE SERVICING	Every 4 discharges or sooner, clean per (I) See (D) if needed.
TOILET TISSUE CORRECT TYPE	See (C)
WINTERIZING	See (J)
	FILTER CAVITATING—Flush unit several times to clear filter of trapped air.
	INSUFFICIENT WATER—Add more water. See Operating Procedures for charging procedure.
	INSUFFICIENT VOLTAGE—Check voltage at motor while flushing. See (A) and (B).
UNIT HAS LITTLE OR NO FLUSH PATTERN	BLOWN FUSE—After checking circuit, replace with 3 AG-10 amp fuse (12 volt) or 3 AG-5 amp fuse (32 volt). Perform (B). CLOGGED OR KINKED FLUSH HOSE—Sanitize, if needed, per (I). Remove cartridge per (K). See (C) or (D) for possible cause. Clean with stiff bristle brush and re-install per (L).
	JAMMED OR CLOGGED FILTER—Sanitize per (I). Remove cartridge per (K). See (B), (C), or (D), for possible cause. Clean with stiff bristle brush and re-install per (L) or replace per (M).
UNIT HAS UNUSUALLY NOISY FLUSH	Perform (B) and (C). Clean per (I) and perform (D), if needed.
UNIT WON'T SHUT OFF AUTOMATICALLY	Remove cartridge cover only per (K) Fig. 1 Do not disconnect. Motor wire has been caught in timer mechanism. Correct and re-install. JAMMED OR CLOGGED FILTER—Perform (B). Sanitize unit per (I). Remove cartridge per (K). See (B), (C), or (D) for possible cause. Clean with stiff bristle brush and re-install per (L) or replace per (M) if needed.
UNIT CONTINUALLY BLOWS FUSES	DEFECTIVE TIMER SWITCH—Remove cartridge cover only per (K) Fig. 1. Check visually. Replace per (M) if needed.
	IMPROPER CLEANING—Clean per (I).
	VENT BLOCKED—See (E)
ODOR	REMOTE LEAK—See (F). IMPROPER CHEMICAL—See (G) and (H).

MAJOR SERVICE POINTS

CARTRIDGE CARE (SEE ALSO CARTRIDGE REMOVAL)

- A** Proper filter and flushing action is dependent on the speed at which the cartridge rotates. If for any reason the cartridge is not receiving proper electrical current, the flushing pattern will be incomplete. Be sure a minimum of #14 (AWG) or larger wire has been used for the connection. Check that no other lights or appliances are on the same circuit. Finally, be sure all connections are securely fastened and free of corrosion.
- B** As a routine maintenance procedure or if the cartridge should clog, remove the wire nuts and reverse wires from timer to motor. This procedure will cause all working parts to rotate in the opposite direction without damaging the cartridge or affecting the strength of the flush.
- C** Standard brands of single ply, non-facial toilet paper available at your local market, such as Zee and M.D., work perfectly well in the Monomatic®. Should you wish to test any other brands for suitability, however, place a small amount in a jar with water and shake vigorously for a few moments. If the tissue goes into a mushy state quickly, it is satisfactory. If it remains whole, avoid using it.
- We do not advise the use of Aqua Soft, Dissolve Away or Pom in the Monomatic®. The Monomatic® operates on a recirculating, filtrating principle and has a rotating filter designed to reject particles larger than .025". These papers, which have been developed for marine toilets with holding tanks, dissolve into extremely fine particles. These minute pieces may pass through the Monomatic® filter and clog the mechanism.
- D** In certain "hard" water areas, a greenish scale can form inside the Monomatic®. Such deposits are generally caused by the high content of calcium in the charging water and especially in the accumulated waste material. To prevent this scale from collecting, add a small quantity of water softener with every other charge of the Monomatic®. The Calgon Company makes a suitable product of this type available at your local market. To remove existing deposits follow **I**.

ODOR CONTROL

- E** Check to be sure vent line is connected to thru-hull fitting and is clear of any obstructions or low points which could trap liquid and block the vent. If the unit is not equipped with vent fitting and air restrictive seat or sailing seal, order them from your distributor.
- F** Check all joints to be sure a slow leak has not developed causing waste to collect in a remote area and become malodorous.
- G** Monogram makes every effort to control the consistent quality of Monochem® chemical. It is possible, however, for a package to be rendered less potent by prolonged exposure to dampness. If it is suspected that your customer may be using defective Monochem®, contact the factory for a package of sample material.
- H** On a few occasions, customers have objected to the particular fragrance associated with Monochem® chemical. Generally, this condition results from adding too much chemical at one time. Always check instructions enclosed in the Monochem® box for most current information.

CLEANING

- I**
1. Empty toilet. Close drain valve.
 2. Lift cartridge as shown in Fig. 5, making sure motor is above toilet.
 3. Pour 8 oz. cup of Vanish or equivalent cleaner into bowl.
 4. Fill Monomatic® to within 1" of brim with water. Flush 3 times. Let solution remain for at least 5 minutes, **but no longer than 30 minutes.**
 5. Rinse thoroughly.

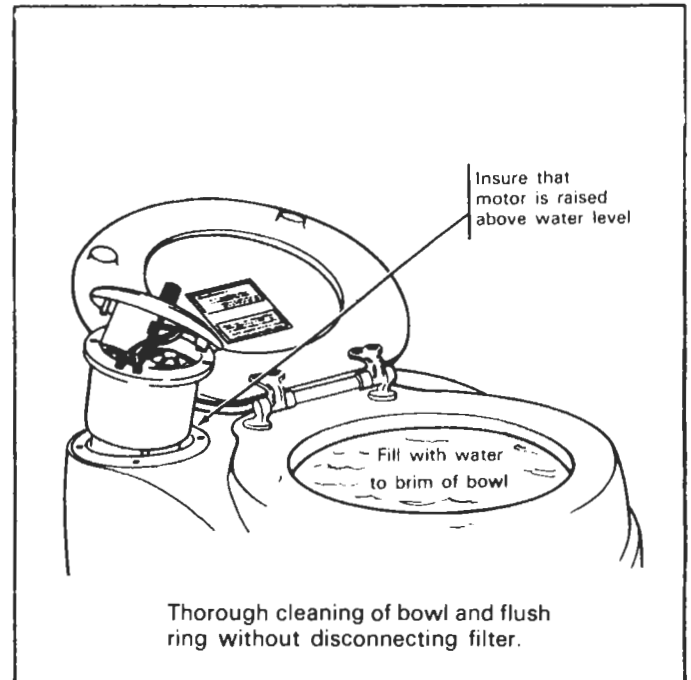

WINTERIZING

J Wet Winter Storage

1. Thoroughly sanitize the unit as described above.
2. Discharge the contents of the entire system.
3. Pour the proper amount of antifreeze into tank. See the antifreeze container for complete instructions. Sufficient antifreeze should be added to protect the initial charge of water in the unit.

CAUTION: USE ONLY ETHYLENE-GLYCOL BASE ANTIFREEZE. DO NOT USE ALCOHOL PRODUCTS.

4. Introduce water into the Monomatic® in the usual manner for charging, until the appropriate charge level has been reached. (Flushing action covers entire bowl.)

Dry Winter Storage

1. Thoroughly sanitize the unit as described above.
2. Remove the cartridge assembly and thoroughly clean it with stiff bristle brush. This procedure is necessary to remove any residue which might harden and later restrict proper filter action.
3. Replace the cartridge.

CARTRIDGE REMOVAL



1
Remove cartridge cover screws and lift cover . . . exposing electrical connectors. Unscrew plastic connection insulators, disconnect electrical wires inside motor housing.

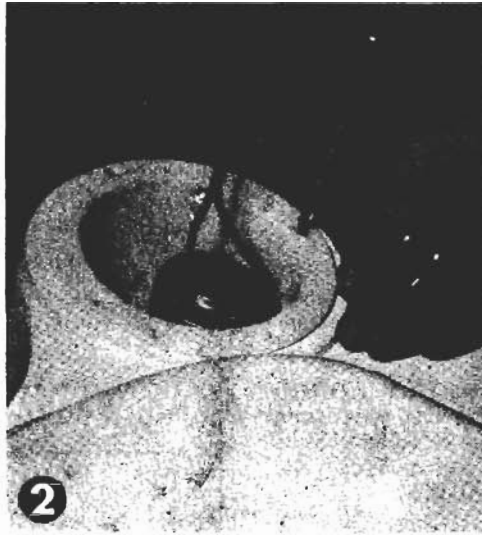

2
Remove four cartridge mounting screws.



3
Pull cartridge assembly upward until hose connection is exposed. Protect plastic tank body with folded cloth and pry off hose connection with screwdriver.

CARTRIDGE INSTALLATION



4
Grasp hose with long nose pliers as shown.

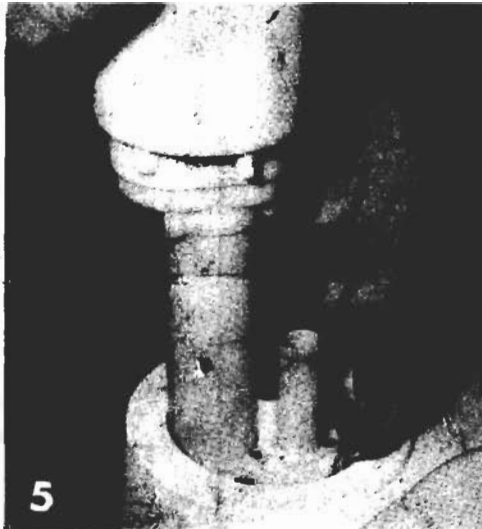

5
Pull hose away to permit insertion of motorized filter pump assembly.



6
Bend hose as shown and push fit $\frac{1}{2}$ to $\frac{3}{4}$ " onto hose nipple of cartridge, make sure red marks on hose and cartridge line up. Use vaseline or glycerin around inside of hose to facilitate insertion.



7
Install gasket, locate to proper hole position. Install four cartridge mounting screws, tighten so that gasket seals between motor housing flange and tank body opening.



8
Reconnect electrical wires, twisting in a clockwise direction. Screw on plastic connection insulators.



9
Carefully insert electrical connections in such a manner so as not to interfere with the timing mechanism. Replace cartridge cover adjusting to a snug fit.

M REPLACEMENT PARTS LIST

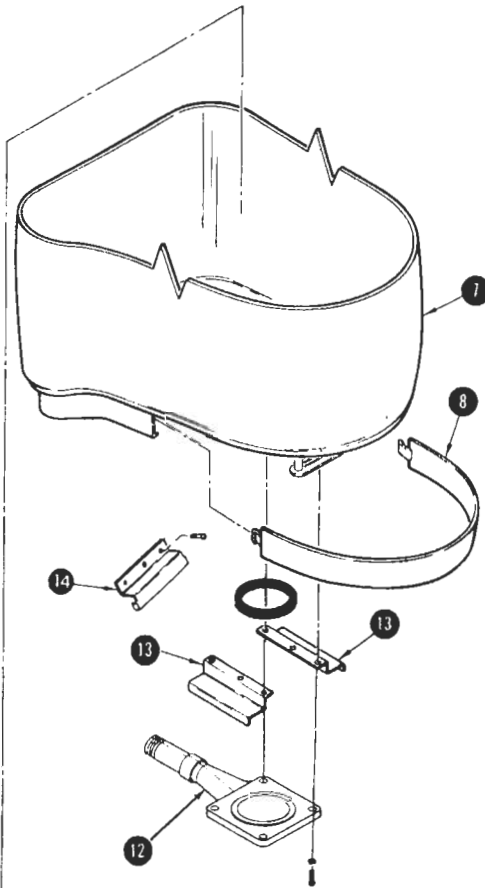
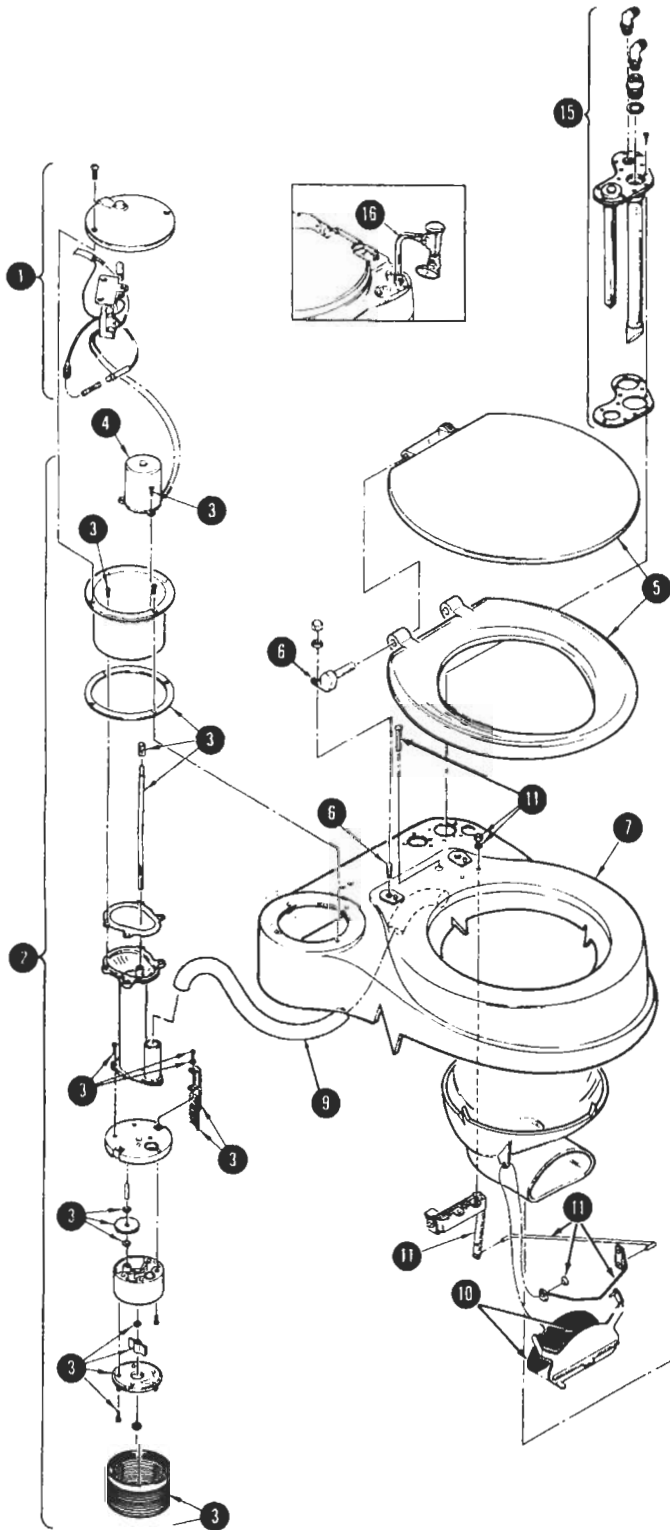

WIRING DIAGRAM

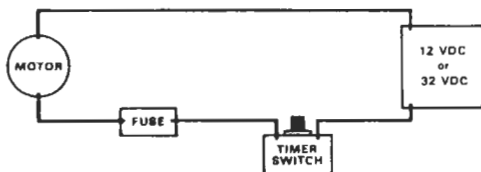

KEY	ITEM	ISE (342)
1	COVER & TIMER ASSY WHITE	119737-1
	BEIGE	2
	AVOCADO	3
	HARVEST GOLD	4
2	CARTRIDGE ASSY 12 VOLT	119700
	32 VOLT	119751
3	CARTRIDGE REPAIR KIT	119727
4	MOTOR KIT 12 VOLT	119728
	32 VOLT	119750
5	SEAT ASSEMBLY WHITE	119717-1
	BEIGE	2
	AVOCADO	3
	HARVEST GOLD	4
6	HINGE—SEAT SET WHITE	119718-1
	BEIGE	2
	AVOCADO	3
	HARVEST GOLD	4
7	SHELL ASSEMBLY WHITE	119741-1
	BEIGE	2
	AVOCADO	3
	HARVEST GOLD	4
8	REMOVABLE SKIRT WHITE	119732-1
	BEIGE	2
	AVOCADO	3
	HARVEST GOLD	4
9	HOSE	119739
10	FLAPPER ASSEMBLY	119722
11	ACTUATOR ASSEMBLY	119723
12	DRAIN FITTING	119749
13	MOUNTING BRACKETS	119745
14	MOUNTING BRACKET, SIDE	119746
15	RINSE - VENT & LEVEL ASSEMBLY	119724
16	WATER INLET VACUUM BRKR. ADAPTER ASSY	OPTIONAL 119747



Monogram Industries

4030 FREEMAN BLVD., REDONDO BEACH, CALIF. 90278