

## RS6+ Pedals Installation

I've always felt that a set of nice metal pedals can be a whole lot more stylish than a plain set of stock ones. Your feet certainly deserve to be pressing down hard on a set of decent material.

I decided to do some research, and at first settled on getting a set of Oettinger pedals. While waiting to decide if that was really what I wanted, the RS6+ arrived on the market. The driver's foot are was adorned with a set of medal pedals that was just awesome looking. It also provided the additional advantage of being a OEM part.

Without further due, please see below for a picture of the pedals I installed, as well as their respective part numbers. You can order any of these pedals from your local dealership by supplying them the part numbers. You can also order them onlin at [VAGparts.com](http://VAGparts.com).

Fig. 0



Accelerator Pedal: 4B7-723-523

Brake Pedal:4B7-723-140

Foot/Support Plate: 4B1-864-777-B

**Warnings:**

Vehicle should be turned off and in 'Park'.

Disconnect your car battery for additional safety precautions.

I assume no liability or responsibility for any damages that may arise either directly or indirectly as a result of the application of the information provided herein.

Please read instructions fully before attempting modification.

Utilize a well lit location to do this modification. Additional lighting will be required.

Area of work is small, dark and full of sharp edges. Please be patient and very careful.

You will be required to work on your back, and in awkward positions. If you suffer of any sort of back pain, I would recommend hiring someone else to do the work.

**Step 1:** Before you embark on getting down and dirty, you must make your work area more accessible. Remove the molding near the instrument cluster as shown in figure 1.

Fig. 1

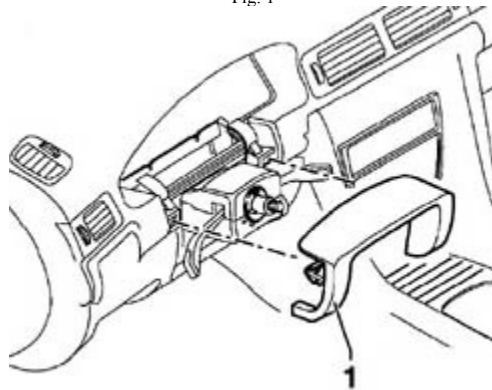

**Step 2:** Remove fuse panel cover as shown in figure 2 below.

Fig. 2

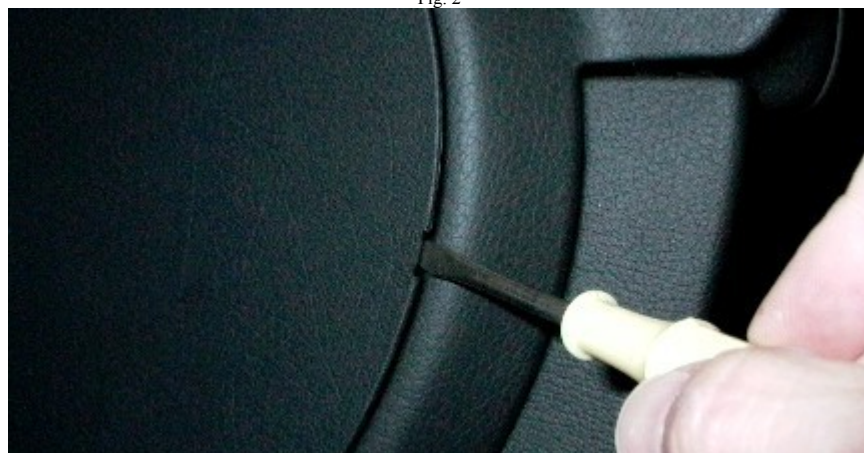

**Step 3:** Remove driver's side compartment by removing the five bolts shown by number 2 in figure 3. Proceed to disconnect footwell light connector as shown by number 3 in figure 3. Finally, unclip the data link connector by squeezing tabs shown by number 5 in figure 3. Once it's all removed and disconnected, set the panel aside but over a soft garmet. You don't want it scratched.

Fig. 3

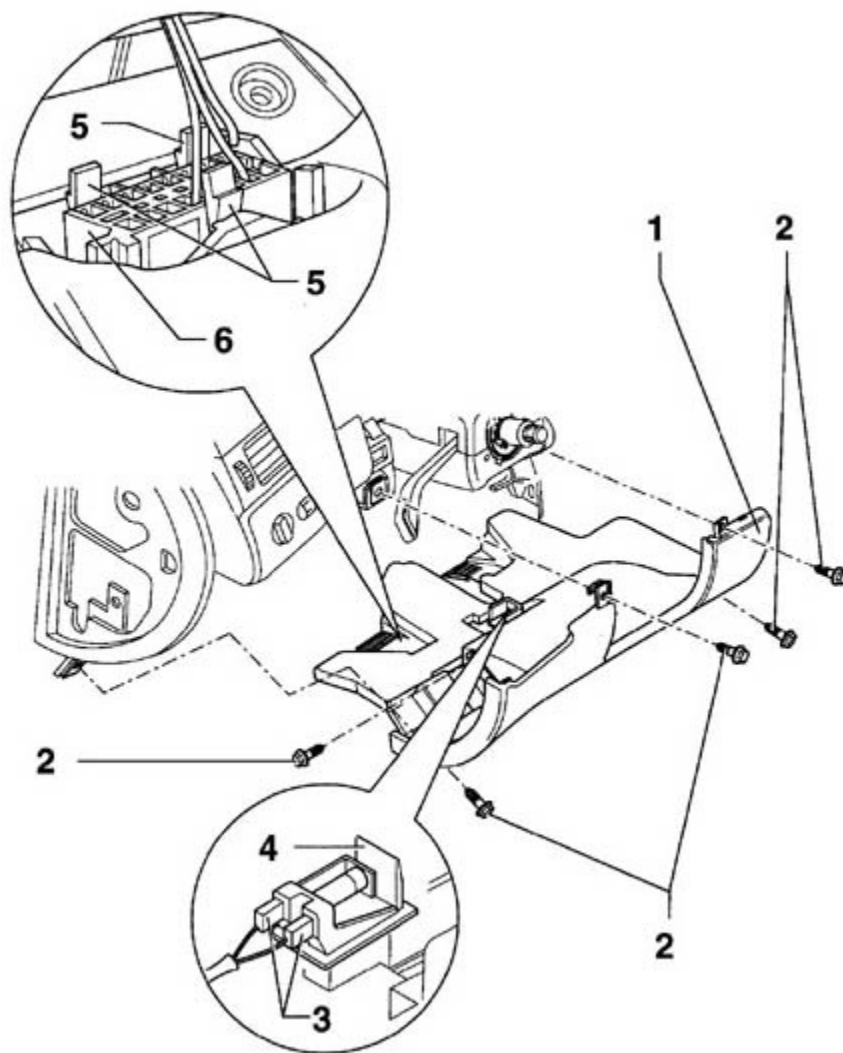

**Step 4:** Loosen bolts on the lower A-pillar foot trim as shown by number 2 in figure 4. This will make it easier to remove the foot/support plate.

Fig. 4

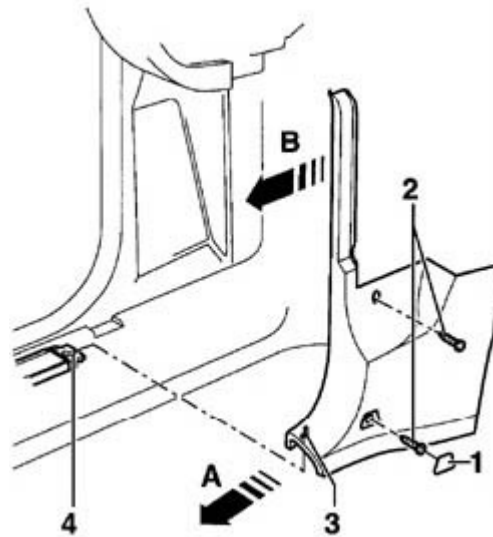

Fig. 4.1



**Step 5:** Now that the whole area is clear, let's get to work. The easiest of the pedals to install is the foot/support plate. This will help you gain some confidence too, in case you need constant positive feedback.

Loosen the bolt as shown by number 1 in figure 5. Use a flat head screw, and push the stock foot/support plate towards the steering wheel. Put some effort into it, and it should come loose. Install your brand new foot/support plate at this time in the reverse fashion. You could wait to install it last if you so wish.

Fig. 5

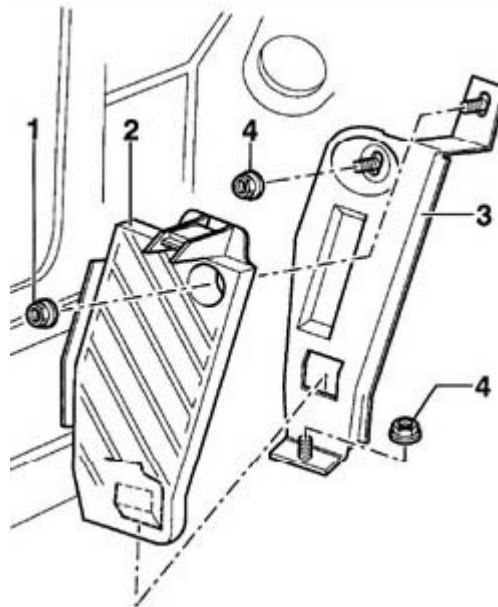
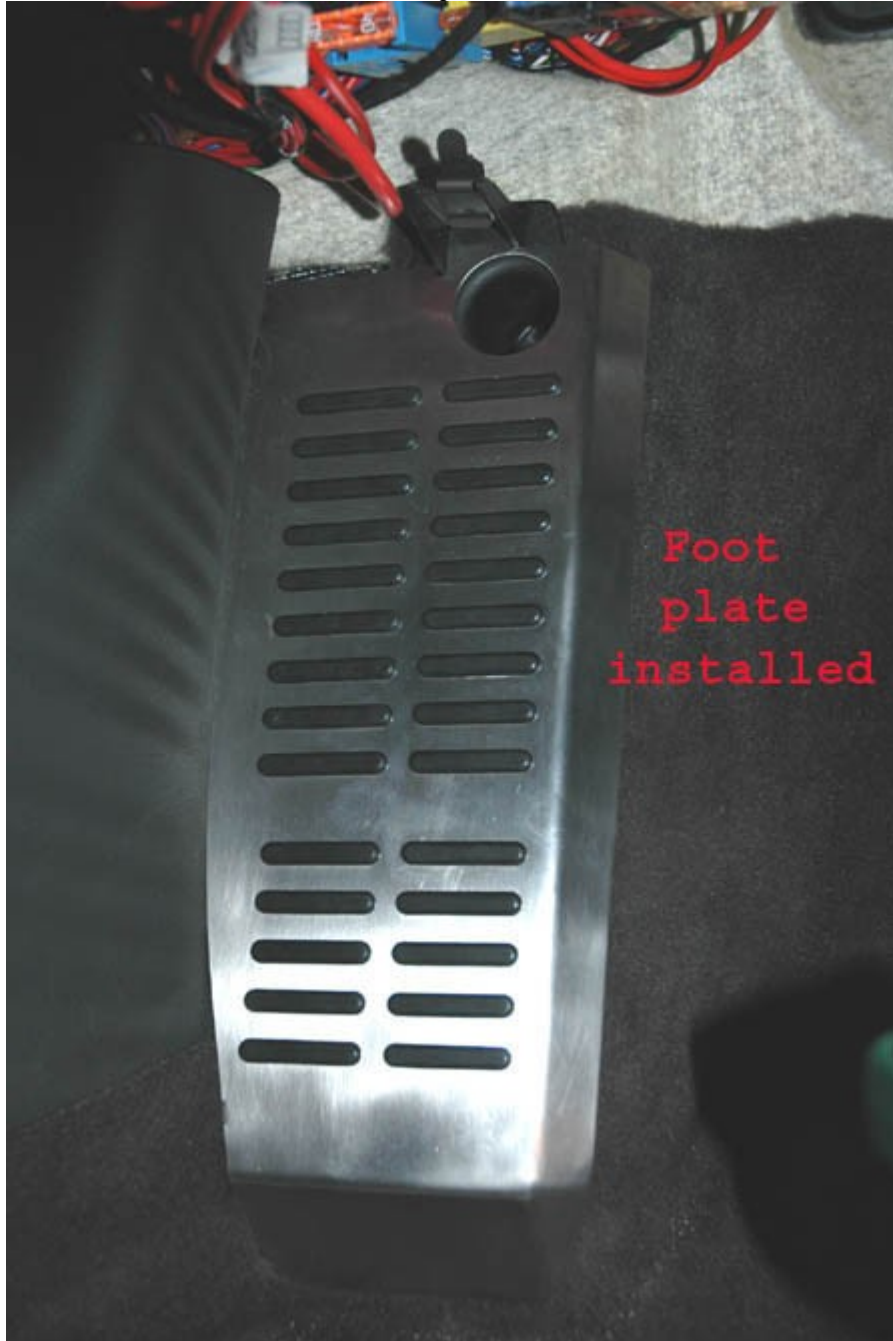

Fig. 5.1



Fig. 5.2



**Step 6:** Before tackling the hard to remove brake pedal, you should remove the spring clip mounted brake light switch, and the 6-pin connector. The assemblies are plastic and should be removed carefully. For the brake light switch, all you need to do is turn it about 10mm in the counter-clockwise direction, and pull the whole assembly out. For the 6-pin connector, push tabs in, and pull connector out.

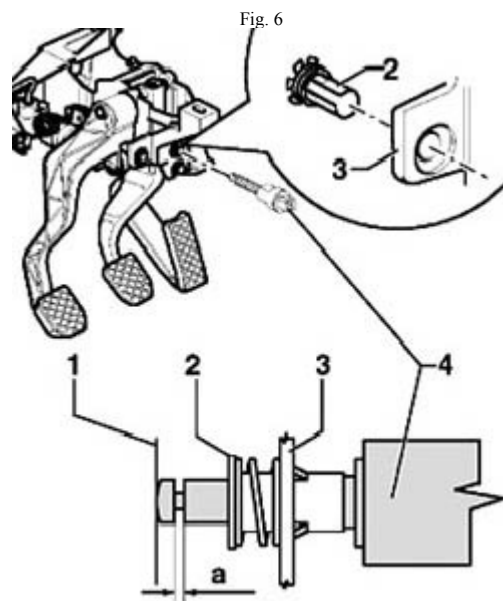
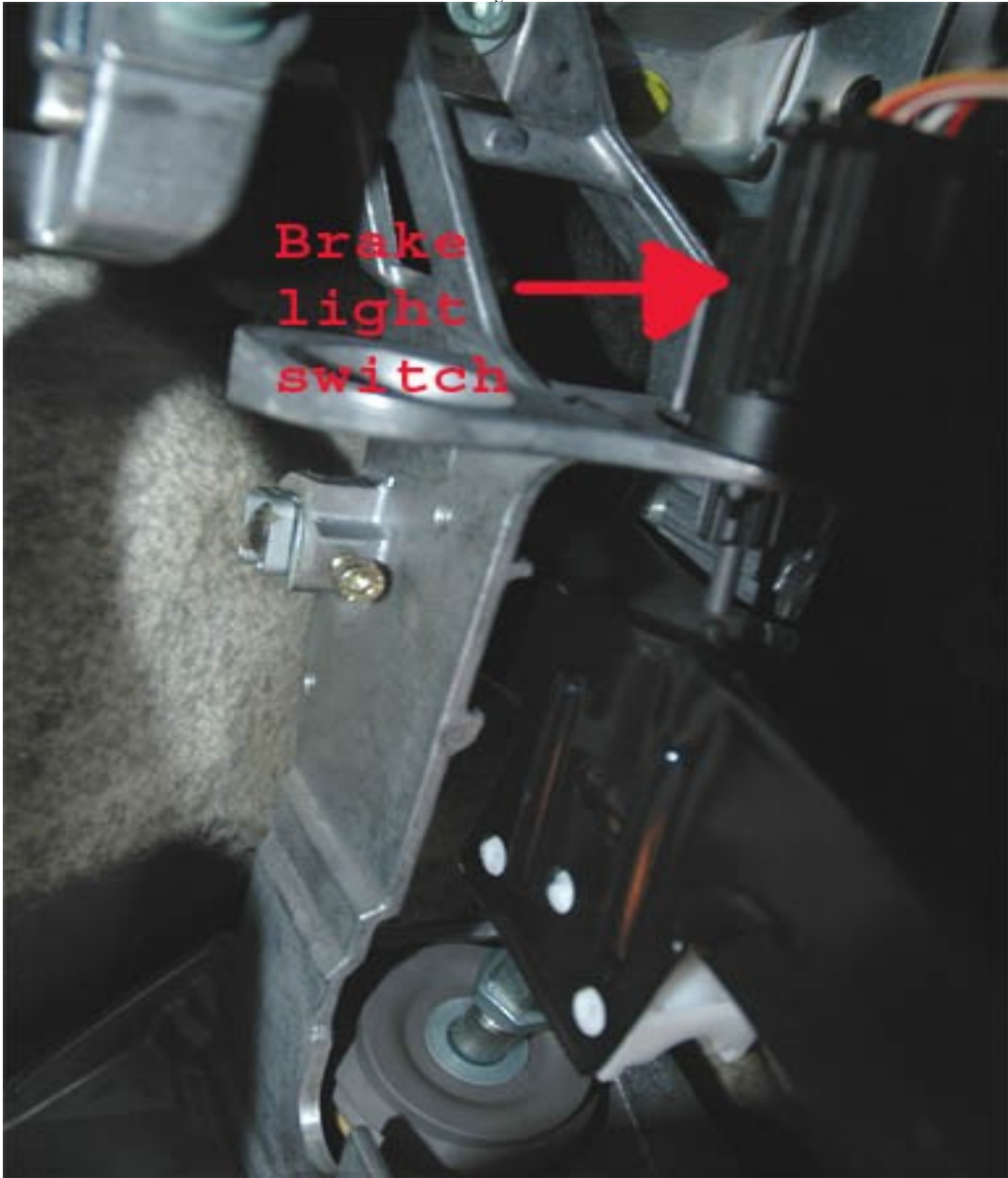

Fig. 6.1



**Step 7:** In order to properly disengage the brake pedal, you should use releasing tool T10006 as shown in figure 7, and do the work shown in figure 7.1. I used a set of hammer ears to pry the tabs, and a bit of force to disengage ball head shown in figure 7.2. Unfortunately, the work was not as successful as I expected because the tabs broke as shown in figure 7.3. However, the ball head came loose. I no longer had any use for the stock brake pedal, so I threw it away as I had done with the stock foot plate.

Fig. 7

T10006



Fig. 7.1

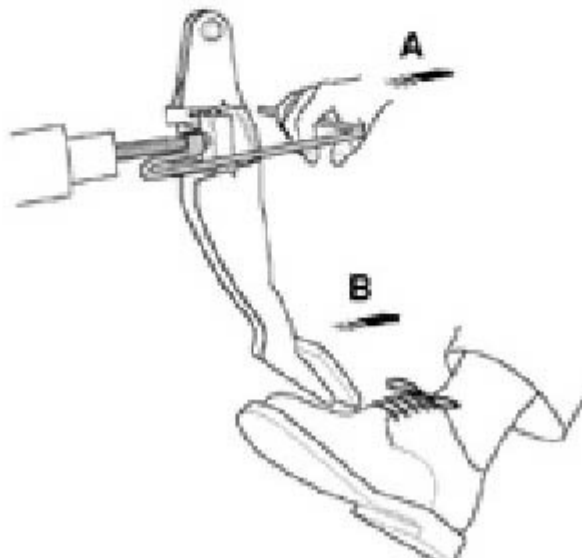
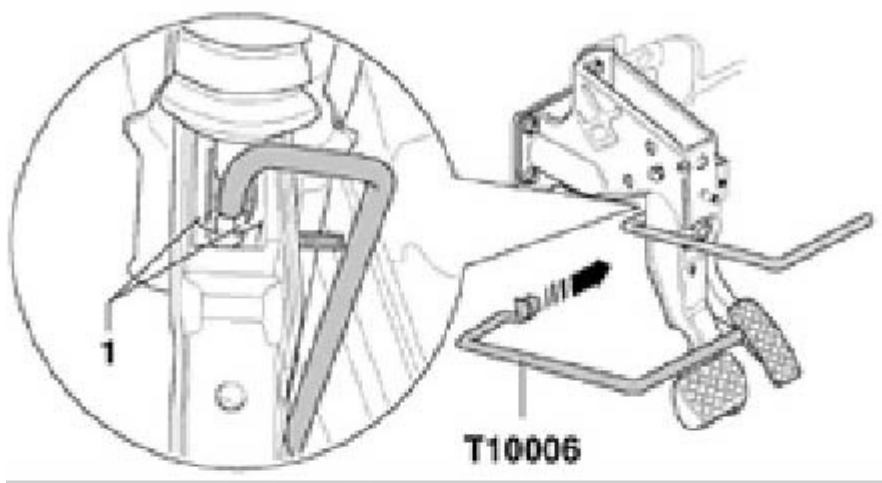

Fig. 7.2

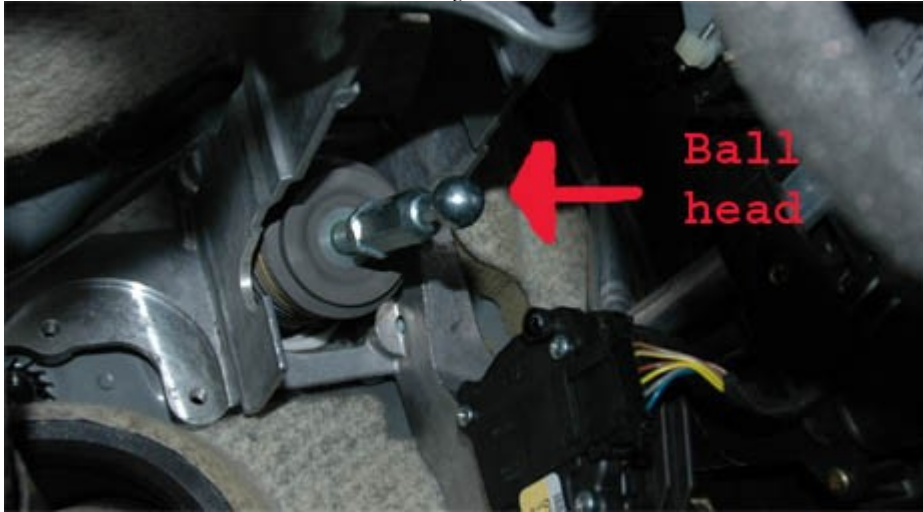

Fig. 7.3



**Step 8:** And now we continue with the remainder of the work to remove the brake pedal. Please see figure 8 for complete brake pedal assembly.

First remove screw shown by number 13 in figure 8 and figure 8.1.

Follow it up with the use of a set of pliers to remove the locking clip as shown by number 3 in figure 8 and figure 8.2. Please keep in mind that there is one of these on each side of the pivot pin shown as number 2 in figure 8.

The pivot pin shown by number 2 in figure 8 should easily slide off with a bit of force, since it's covered with a tiny layer of grease. You can see the pivot pin and the locking pins removed in figure 8.3.

You will need a little bit of grease to re-insert the pivot pin. You can use a bit of oil from the container in your trunk. Don't install your new brake pedal just yet. Remove and install the accelerator pedal first. Once done with step 9 of uninstalling the stock accelerator pedal, and installing your new RS6+ accelerator pedal, proceed to install your new RS6+ brake pedal in reverse of the unistall process.

Tip 1: Remove locking pin that faces driver's side door first.

Tip 2: Slide the pivot pin towards center console to allow you more visibility of second locking pin.

Tip 3: Oil up the pivot pin before installing the brake pedal back on.

Tip 4: As the tip of the pivot pin enters the top of the brake pedal it will stop there. Blame it on the whole that the pivot pin enters. The oil/grease will help it slide in, but only about 5mm. It should be enough to make sure it's lined up with the top of the brake pedal entry. Use hammer and tap the pivot pin in gently. Do this various times. Once about 15mm in, it will be easier to go all the way. This part really scared me, as I was almost sure it would not go in all the way, but it did.

Tip 5: Just use your fingers to snap locking pins in. Quite easy for the driver's door side, but a bit more acrobatic for the center console side.

Fig. 8

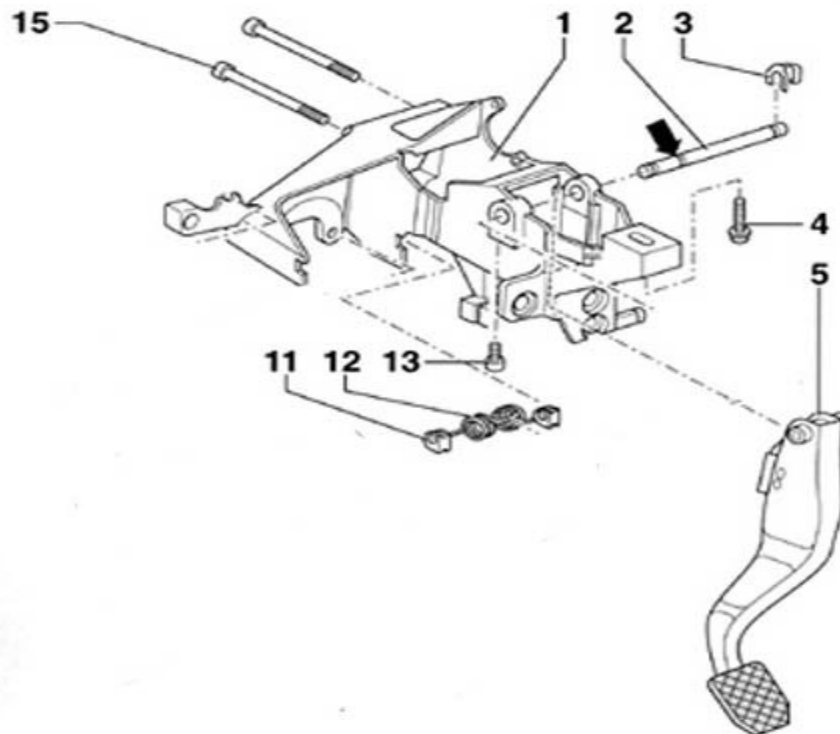

Fig. 8.1

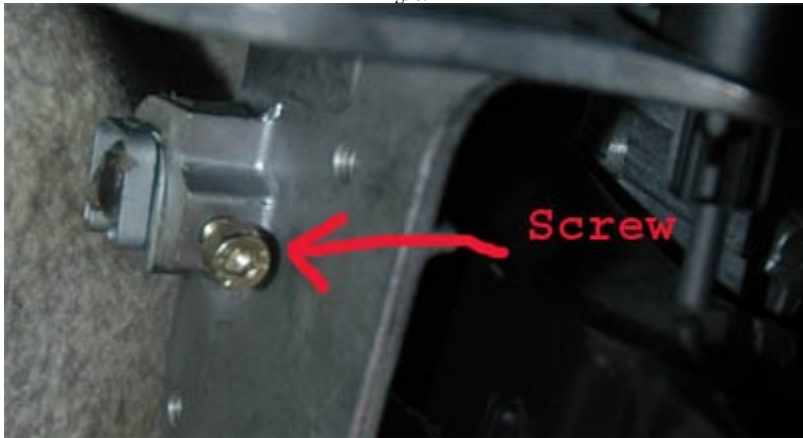

Fig. 8.2

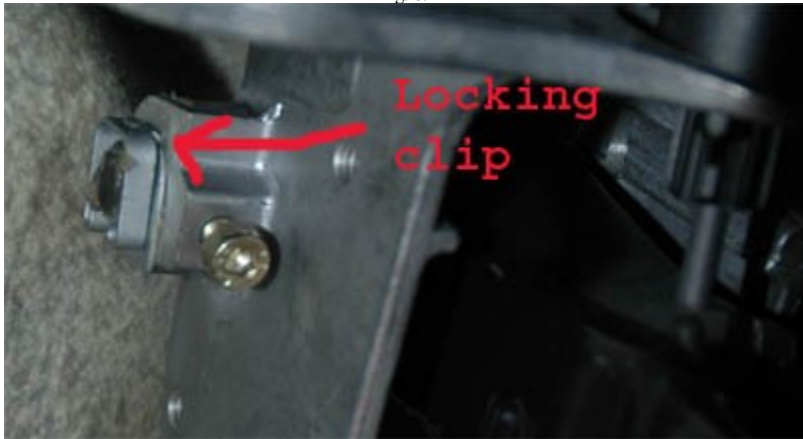

Fig. 8.3



**Step 9:** In order to remove the accelerator pedal, you must first remove the 6-pin connector shown by number 3 in figure 9. Push tabs inward, and pull out the connector. Once you've done so remove lower screw as shown by number 4 in figure 9. Lastly, remove both screws on the top as shown by number 2 in figure 9. Please keep in mind that the top screws are harder to get to, as they are at an angle as seen in figure 9.1.

Install the pedal in reverse of uninstall.

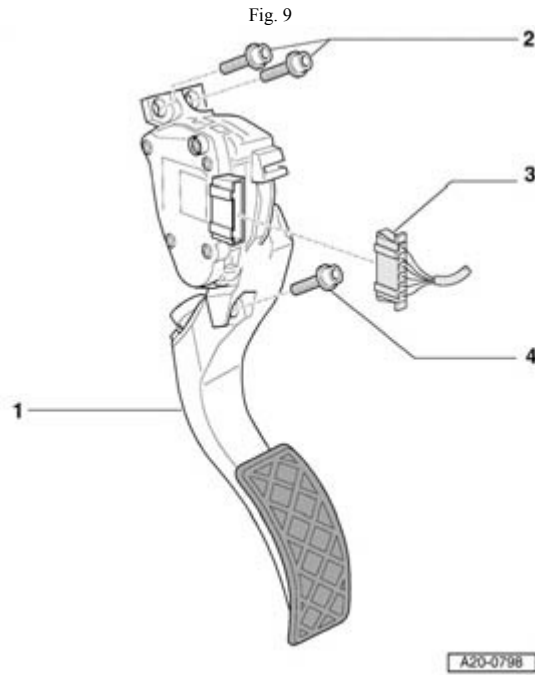
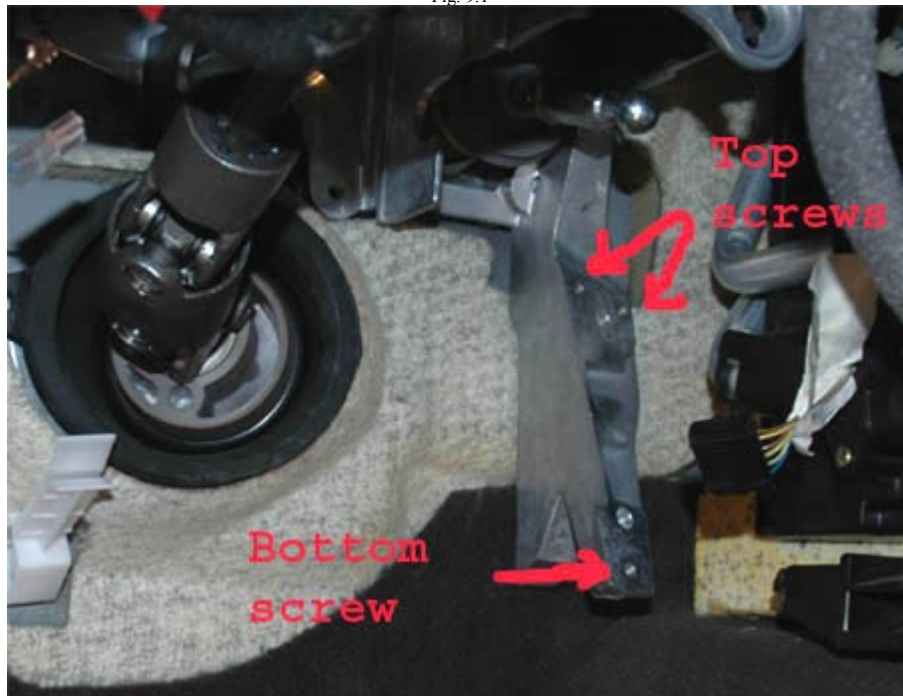

Fig. 9.1



**Goal:** Here is a picture of the work once I was all done.

Fig. 10



Fig. 10.1



**Bonus Round:** I decided to take apart my stock accelerator pedal before I threw it in the trash, so I could see what this whole 'drive-by-wire' technology is all about.

Fig. 11



Fig. 11.1



Fig. 11.2



Fig. 11.3

