

Glazing and Opaque Door Schedule											
Glazing Number	Plan page	Manufacturer/Model No. and Special Features	Product Type	Size		area (sq. ft)	Qty	total area (VGA)	U-Factor		VGA x U=
				w	h				NFRC-certified	Default	
1	A-4	Reliant French Door/Item 135841	swing door	72	80	40.00	1	40	0.32		12.8
2	A-4	Therm Star	slid. win.	48	48	16.00	10	160	0.35		56
3	A-4	Therm Star	slid. win.	36	36	9.00	1	9	0.35		3.15
4	A-4	Therm Star	slid. win.	30	48	10.00	1	10	0.35		3.5
5	A-4	Therm Star	fixed. win.	24	24	4.00	3	12	0.35		4.2
6	A-4	Therm Star	slid. win.	44	48	14.67	3	44	0.35		15.4
7	A-4	Therm Star	slid. win.	48	42	14.00	3	42	0.35		14.7
Total VGA=							209	Total VGA x U=		71.95	
Area-Weighted Average Vertical Glazing U-Factor = (Total VGAXU)/(Total VGA) =											0.344258

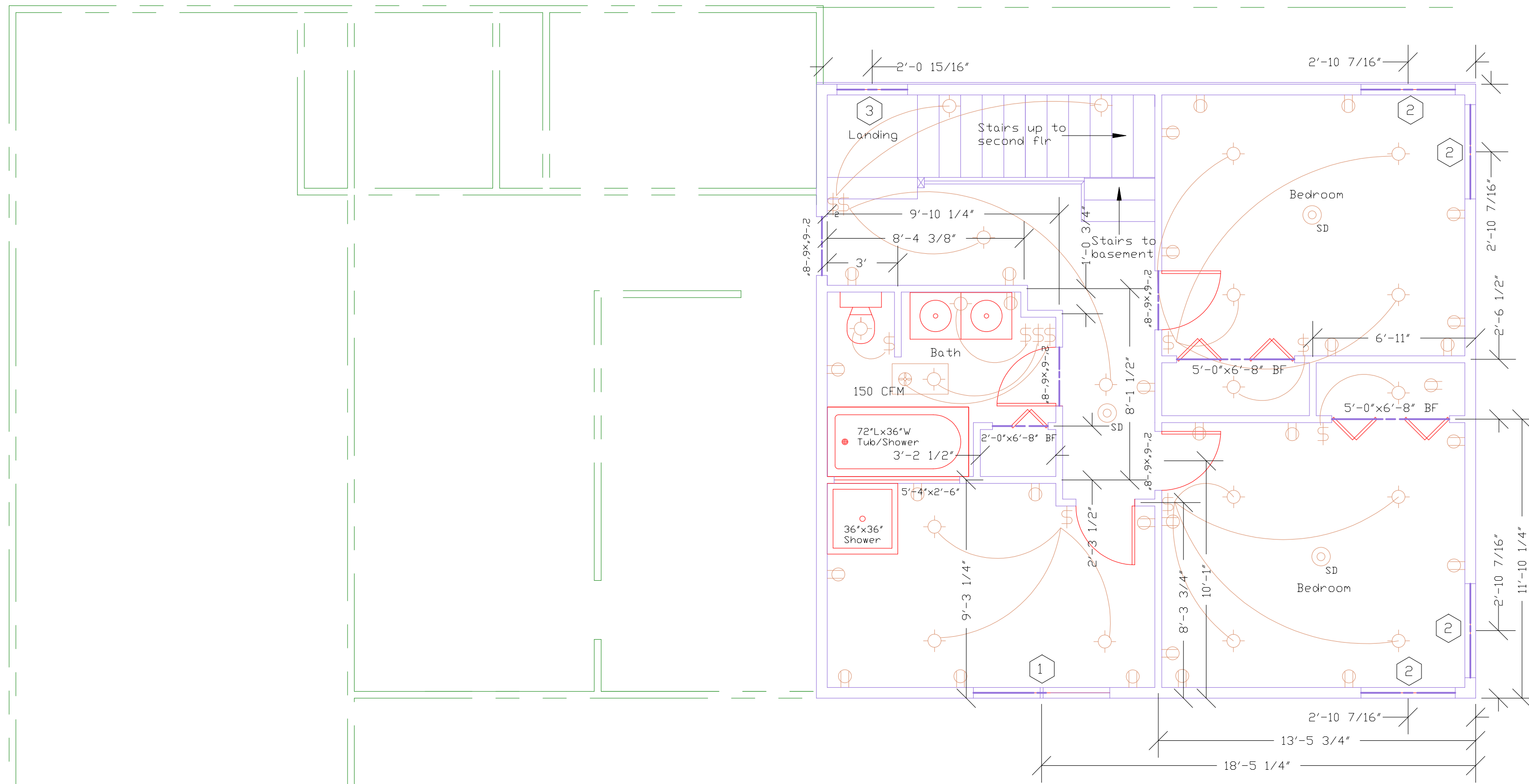

Existing floor and new main floor
Scale: 1/4" = 1'- 0"

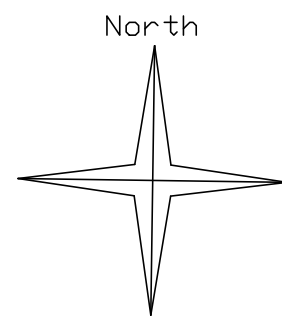
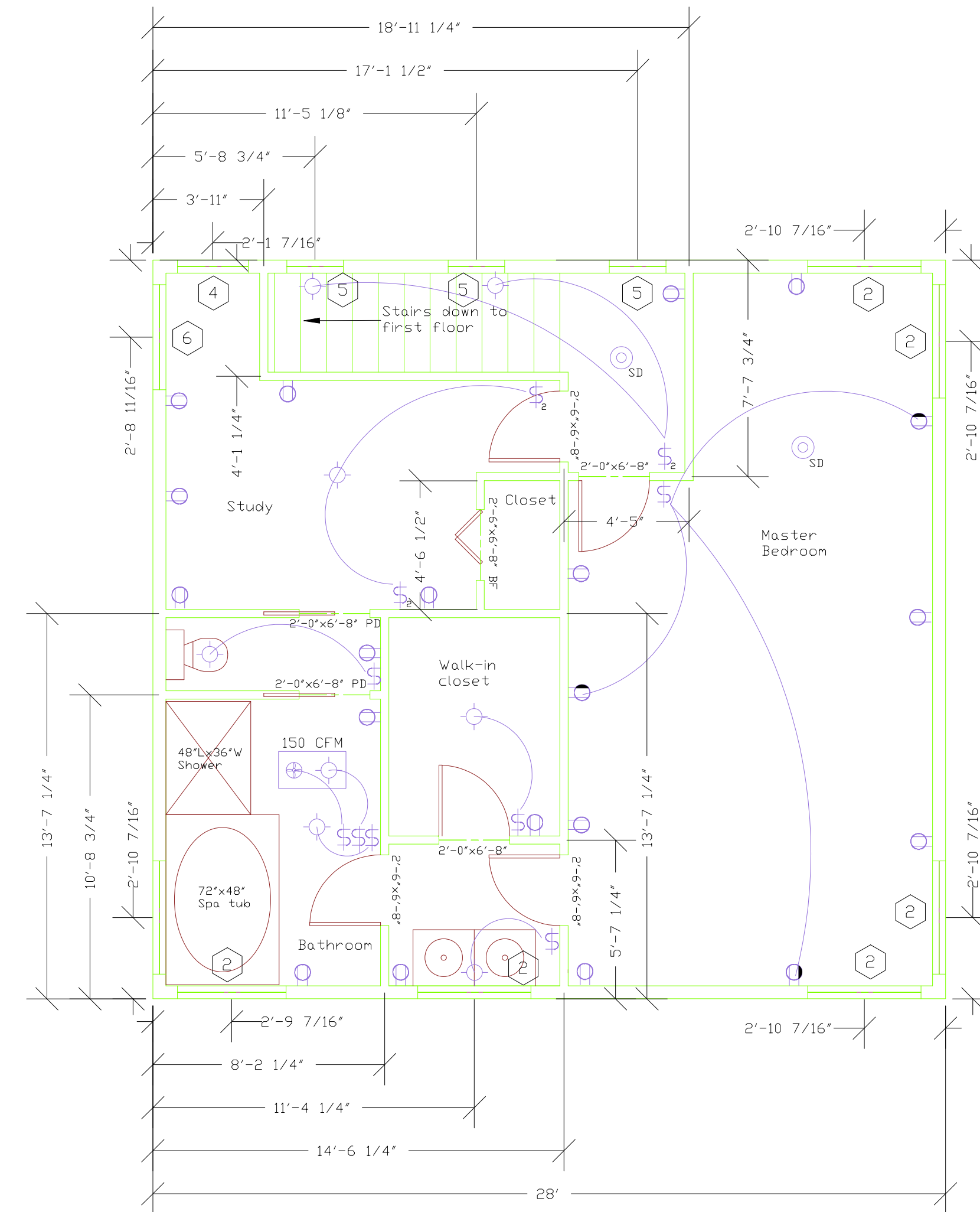

New Second story plan
Scale: 1/4" = 1'- 0"

FLOOR PLANS

DATE: 7/23/06

REVISION: New

