

Barn Owl Nestbox Plans

PLANS FOR A BARN OWL NEST BOX
SUITED FOR SOUTHERN ONTARIO

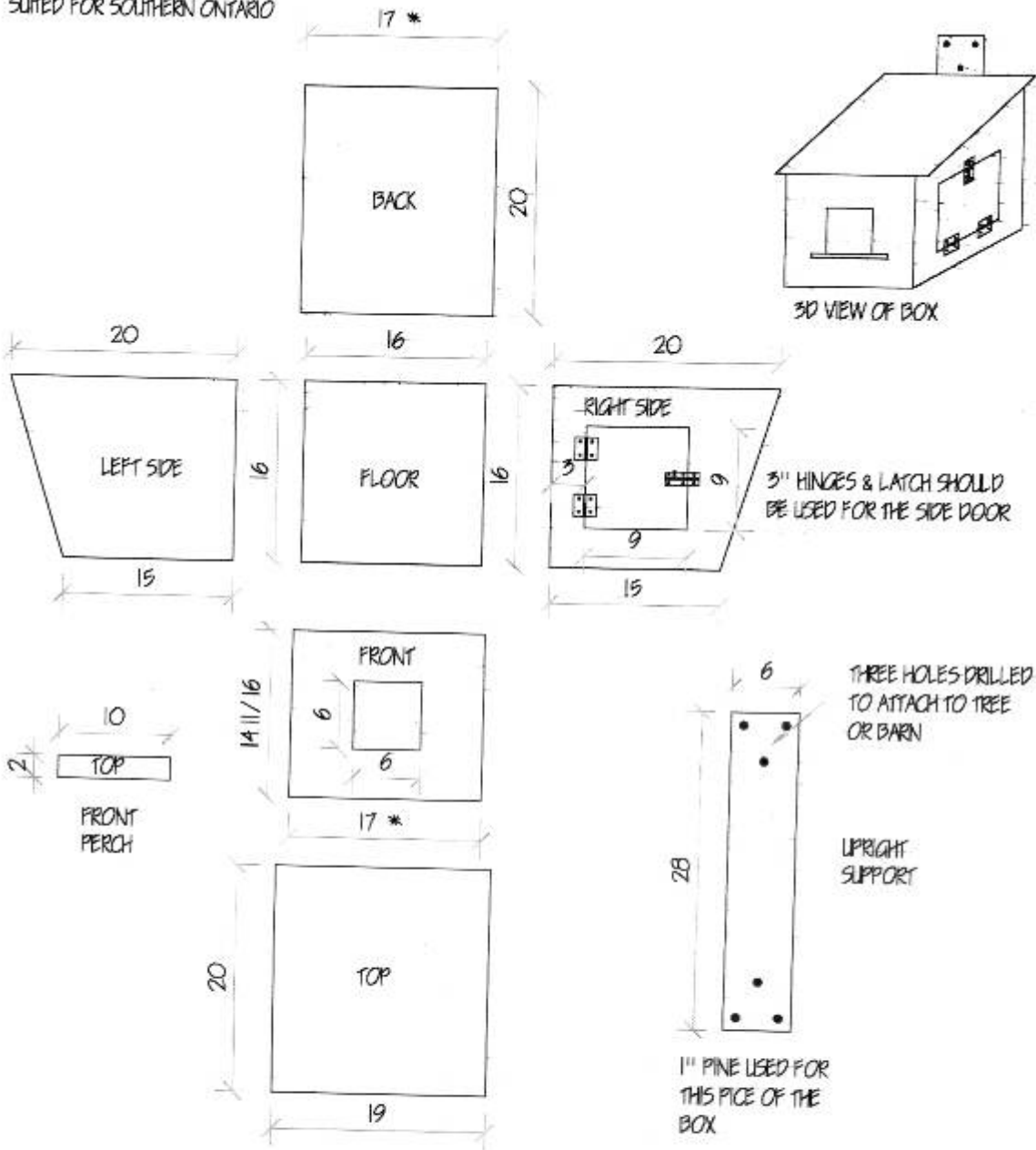

TOP OF THE BOX SHOULD BE PAINTED FOR WEATHER PROTECTION
 BOX SHOULD BE MADE OF 1/2" PLYWOOD
 SHOULD BE PUT TOGETHER WITH 1 1/2" WEATHERPROOF SCREWS
 ALL MEASUREMENTS IN INCHES
 WOOD GLEW SHOULD BE USED TO SEAL SCREWED AREAS
 SCALE: 1" = 1' - 0"

* FOR 3/8" PLYWOOD
 USE 16 3/4

DRAWN BY: SCOTT SOSTAR

Materials List:

1 sheet of 4 x 8 x 1/2 inch plywood	1 - 3 inch latch
1 piece 1 x 6 x 28 inch pine (mounting board)	1 container of white wood glue
1 piece 1 x 2 x 10" pine (perch)	1 box of 6 x 1 inch weatherproof screws
2 - 3 inch hinges	18 - 6 1/2 inch weatherproof screws

Instructions

- Cut out all pieces of plywood and pine using table saw or circular saw
- Take the front panel and trace the 6 x 6 inch opening on it. Drill a 1/4 inch pilot hole in one corner and then cut all the way around the square with a jig saw
- Take the right panel and trace the 6 x 9 door on it and follow same cutting instructions as above.
- NOTE - When starting to assemble the box ensure that the screws are set far enough back at the corners so that they do not run into each other. Pre-drill all screw holes with a 3/32" bit.
- Take the floor panel and run a bead of glue along two opposite sides
- Take the left panel and line the bottom panel flush with the floor panel on the glued side. Now take 4 - 1" screws and screw them in evenly along the left side into the floor panel.
- Repeat the same process for the right side.
- Run a bead of glue along the back edge of the floor panel and the back of the right and left side panels. Take the panel and place it flush with the floor and two side panels.
- Screw the back panel in place with 4-1" screws on each of the 1 bottom and 2 side seams.
- Install the front panel in the same manner as the back panel.
- Install the front perch using 3-1" screws and a bead of glue. Place it just below the front opening, centered side to side on the front panel.
- Take the mounting board and mark its centre and screw it into the back panel, making sure that it is centered from side to side and top to bottom. This should give you an even amount of wood protruding beyond the back panel, top and bottom, for mounting.
- Install the two hinges on the bottom of the right side door and the catch section or the latch on the top. Mount the door onto the side panel so that it opens downward as illustrated. Install the bolt section of the latch on the side panel directly above the latch catch. Use the 6 x 1/2 inch screws for section.
- Install the top panel with the back touching the mounting board and an even amount of overhang on both sides. Use 4-1" screws on each seam.
- Paint the top panel (flat surface and particularly the edges) with brown paint for weatherproofing.
- Drill 5-1/4 inch holes evenly spaced in the bottom panel for drainage.